



Fitting Instructions

RT905

RENAULT ESPACE
2003 ON

Bolt Kit

WA	12	14MM LARGE ROUND WASHERS
A	2	16x50 BOLTS, NUTS & GRIP WASHERS
B	4	14x35 BOLTS, NUTS & GRIP WASHERS
C	2	14x40 BOLTS, NUTS & GRIP WASHERS
D	2	12x150 BOLTS, NUTS & GRIP WASHERS
E	2	12x90 BOLTS, NUTS & GRIP WASHERS
BU	2	32 x 40MM BUSHES
SP	2	SPACERS

Contents

CB	1	CROSSBAR
CS	1	CENTRE STRUT
SA	2	SIDE ARMS

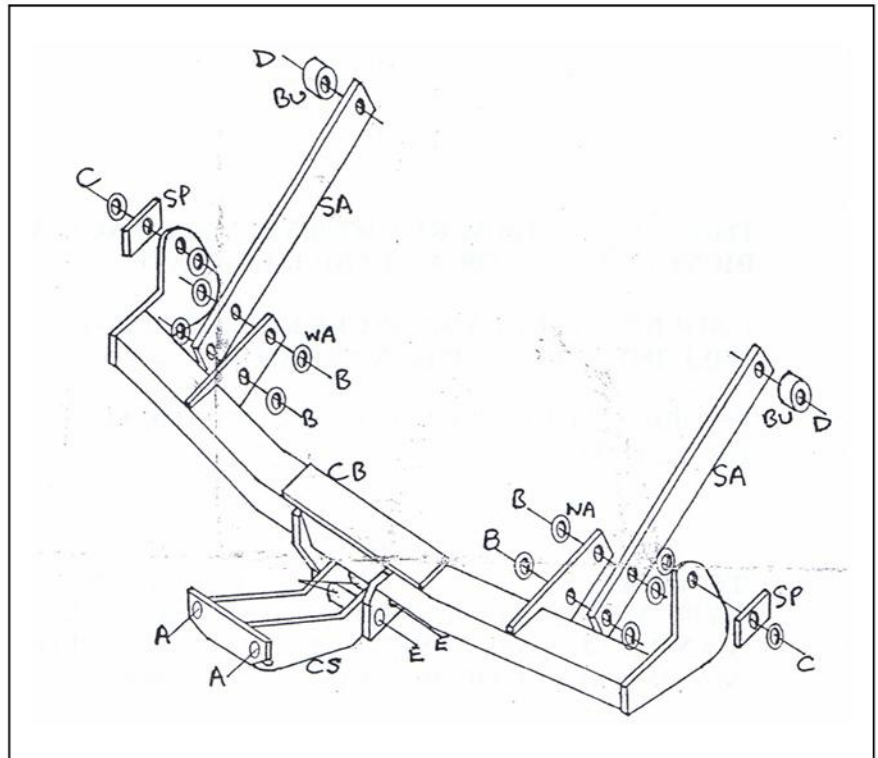

1. LOWER THE SPARE WHEEL. REMOVE THE DIRT GUARDS FROM EACH SIDE (REAR OF THE BACK WHEELS 2 SCREWS) AND LOWER THE EXHAUST.
2. ATTACH THE CROSSBAR CB USING BOLTS C WITH SPACER PLATES SP AND WASHERS WA IN PLACE.
3. REMOVE REAR WHEELS AND ATTACH SIDE ARMS SA TO THE CHASSIS USING BOLTS D (WITH BOLT HEADS ON THE OUTSIDE) AND BUSHES BU IN PLACE BETWEEN THE CHASSIS AND SIDE ARMS. ATTACH SIDE ARMS SA TO THE CROSSBAR CB USING BOLTS B AND WASHERS WA. WITH THE CROSSBAR PUSHED UPWARDS TIGHTEN ALL BOLTS.
4. REFIT WHEELS, DIRT GUARDS AND EXHAUST. ATTACH CENTRE STRUT CS USING BOLTS E AND BUSHES BB.
5. CHECK AND TIGHTEN ALL BOLTS.